

JETLINE

HIGH PERFORMANCE IN-LINE DUCT MOUNTED FAN

5*
YEAR WARRANTY

IP44

**EURO
MADE**

**ULTRA
QUIET**

The Jetline is a high performance, low profile in-line fan featuring silent-block motor mounting to reduce vibrations and provide low noise operation. The Jetline uses a quick-fit mounting bracket for fast installation and is suitable for mounting in any position.

Jetline is suitable for toilets, bathrooms, ensuites, laundries and kitchens in homes, hotels, apartments, and commercial buildings. There are 6 models in the range matching standard duct sizes from 100 to 315mm diameter.

- High performance patented centrifugal impeller.
- Designed for direct connection to standard diameter circular ducting.
- Low profile, durable outer casing manufactured from galvanised sheet steel.
- Galvanised steel quick fit mounting bracket for fast installations.
- Rubber gasket on spigots improves seal between fan and duct work.
- Can be mounted in any position.
- Includes plug and lead for easy installation.

DIMENSIONS

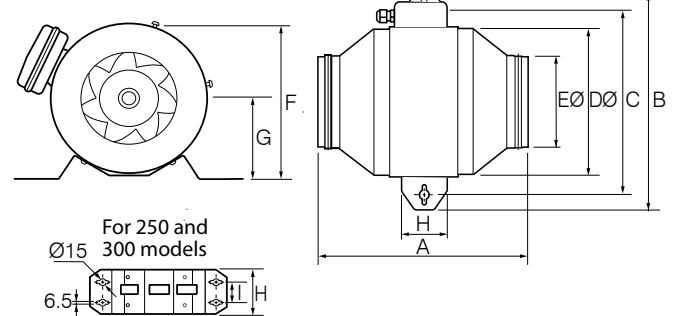

MODEL NO.	A	B	C	DØ	EØ	F	G	H	I	WEIGHT KG
JETLINE-100	276	306	256	181	95	190	98	70	-	3.0
JETLINE-125	279	315	265	206	120	214	111	70	-	3.4
JETLINE-150	323	348	299	244	145	252	130	70	-	4.5
JETLINE-200	322	369	320	273	195	281	145	100	-	5.6
JETLINE-250	329	375	326	293	245	301	155	120	50	6.5
JETLINE-315	369	407	358	322	310	331	170	120	50	10.0

All dimensions in mm

SPECIFICATIONS

MODEL NO.	M ³ /HR†	L/SEC†	FAN SPEED REV/SEC	AVG. dB(A) @ 3M**	WATTS	1PH AMPS	VOLTS
JETLINE-100	260	72	45	35	19	0.1	220-240
JETLINE-125	420	117	44	41	40	0.2	220-240
JETLINE-150	750	208	46	46	83	0.4	220-240
JETLINE-200	1080	300	44	51	125	0.5	220-240
JETLINE-250	1280	356	45	53	160	0.7	220-240
JETLINE-315	1610	447	43	52	215	0.9	220-240

** Inlet sound levels

† Air flow without duct and fittings

*Conditions apply. For details visit: fantechtrade.com.au/warranty