

THE Bucket Company

The WEIGHT is over!

INSTRUCTION MANUAL

RUNOFF PUMP

Fittings Assembly
Pump Assembly
Power Cord Assembly
Pump Discharge Assembly



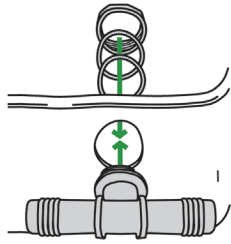

Fittings Assembly: [See page 1](#)

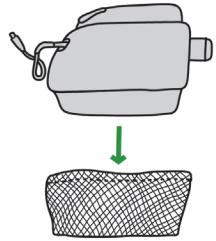

Pump Assembly: [See page 2](#)

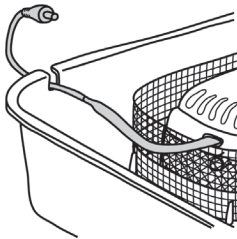

Power Cord Assembly: [See page 3](#)

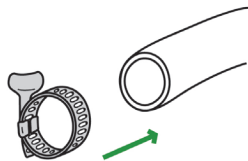

Pump Discharge Assembly: [See page 4](#)

Company Information

www.thebucketcompany.com

(786) 580- 3990 | sales@thebucketcompany.com

Copyright © 2020 The Bucket Company

1

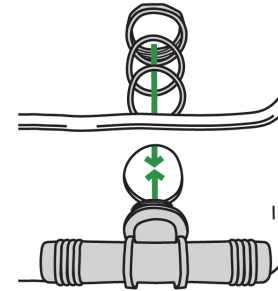

Step #1: Insert 3/8" MPT - 3/4" Barb Tee fitting on the left side or right side of the container. Place the (2) silicone Washers and (1) Nut in the inside of the container. Hold the silicone washers and nut inside of the container and twist the Barb T on the outside until securely fastened.

2

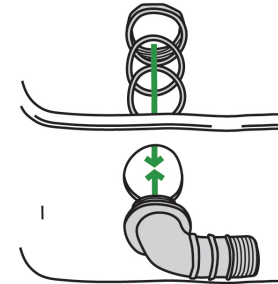

Step #2: Insert 3/8" MPT -1/2" MPT or 3/4" Barb Elbow fitting on the left side or right side of the container. Place the (2) silicone Washers and (1) Nut in the inside of the container. Hold the silicone washers and nut inside of the container and twist the 90° Elbow on the outside until securely fastened.

Note: Elbow fitting can be adjusted to the direction of your choice by rotating once connected to the container.

3

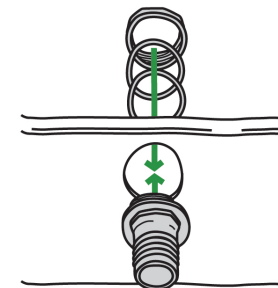

Step #3: Insert the 3/8" - 3/4" Straight Fitting to the opening on the rear of the container which is slightly higher than the holes on the sides and serves as an overflow or for daisy chain connections. Hold the silicone washers and nut inside of the container and twist the Straight Fitting on the outside until securely fastened.

Note: 3/4" End-caps are used to plug any open ended fittings.

1

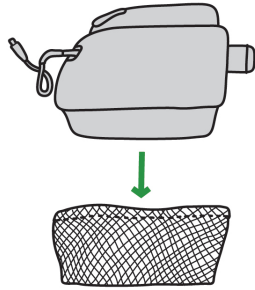

Step #1: Remove Pump out of box and place White Mesh Filter from fitting bag around the bottom of the pump of your choice.

Note: The 1100GPH pump connects directly to the Pump outlet Fitting while the 750GPH pump includes an increasing adapter that needs to be directly inserted to the Pump Outlet Fitting before connecting to the 750GPH pump.

2

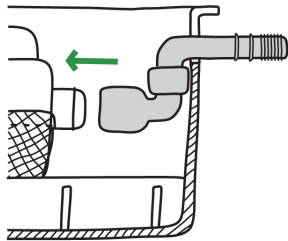

Step #2: Connect the pump to the Pump Outlet Fitting, then twist and position the barb fitting towards the outside of the box.

3

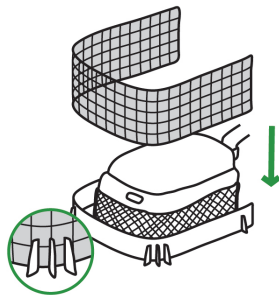

Step #3: Install the black filter around the outer perimeter between the plastic wall and plastic holders.

1

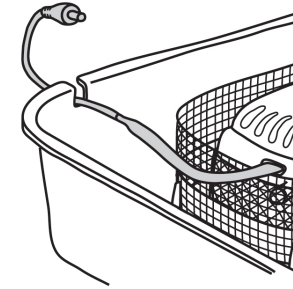

Step #1: Place the pump power cord through the U-Shape opening on the right side of the container.

2

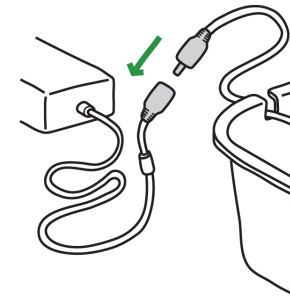

Step #2: Connect the pump to the power adaptor using the male and female connections.

3

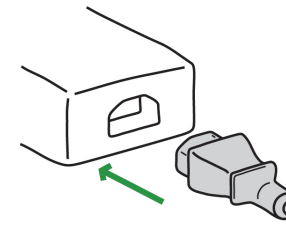

Step #3: Remove the wall outlet cable and connect into the AC/DC adaptor plugin.

1

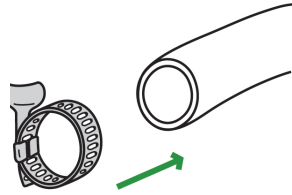

Step #1: If using Vinyl Tubing, remove the hand twist clamps and slide over the 3/4" Tubing before connecting the hose to the Pump Outlet Fittings.

Note: Doing this stabilizes your pump and helps prevent water from leaking.

2

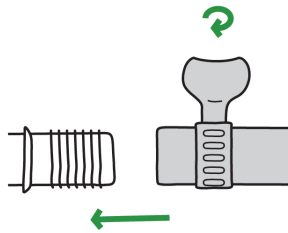

Step #2: Connect Vinyl tubing to the fittings and tighten the clamps by twisting until securely fastened.

3

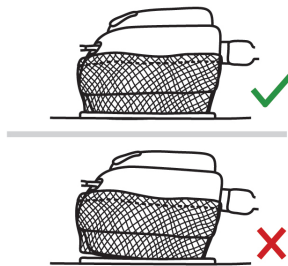

Step #3: Make sure the pump is not sitting on the lip of its location and completely flat and leveled after you have connected the Pump Outlet Fitting.

Note: Minimize any elbows on the discharge of the pump as this will lower the pumps overall capacity and pressure. 90% of problems occur due to pump not being leveled.

4

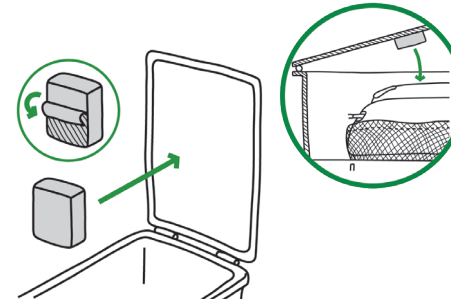

Step #4: Remove black foam square foam from the box and peel adhesive layer. Place directly on the inside lid above the pumps location. This will maintain the pump flat and level when the black lid is closed.

Note: The foam square should end up resting on top of your pump when the lid is closed.

5

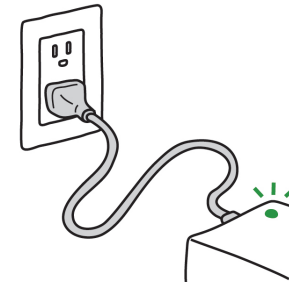

Note: 2" of water is needed for float valve to turn on automatically.

Step #5: Once everything has been connected, connect the power supply cord to the wall outlet and make sure the green light is turned on the AC/DC Adaptor.

Note: Before connecting to your system, test the pump by pouring water until the built in float valve turns on automatically.



THE
Bucket+Company
The WEIGHT is over!

www.thebucketcompany.com

(786) 580- 3990 | sales@thebucketcompany.com

Copyright © 2020 The Bucket Company